

**SIDEWALK, CURB OR CURB CUT  
PERMIT APPLICATION**

<b>PROPERTY OWNER'S INFO</b>	TRACKING No: -
Name: _____ Phone: _____	
Address: _____	
<b>PROJECT LOCATION:</b>	<b>LOT #:</b>
<b>APPLICANT/CONTRACTOR INFORMATION:</b>	
Name: _____ Phone: _____	
Address: _____	
Email: _____	
Indicate below the type of work to be completed:	
New: <input type="checkbox"/> Replacement: <input type="checkbox"/> Curb Cut: <input type="checkbox"/>	
1. Curbing _____ If Curb w/gutter _____ If	
2. 4" Sidewalk _____ ft. wide by _____ ft. long	
3. _____" Driveway _____ ft. wide by _____ ft. long	
*** For new construction, submit a copy of the approved site plan or submit plans for approval***	
I hereby certify that the Owner of Record authorizes the proposed work and that I have been authorized by the owner to make this application as his "Authorized Agent" and we agree to conform to all applicable laws of the City of Piqua, Ohio.	
<b>SIGNATURES:</b>	
Signature of Applicant _____ Date: _____	
All forms must be in place and graded prior to placement of concrete; no work is to continue beyond the forms stage until accepted by the city's designated inspector. Call at least 24 hours prior to schedule an inspection.	
<b>APPROVED BY:</b>	
City of Piqua	
Signature: _____ Date: _____	
Fee: _____ Date: _____ Receipt No. _____	
New drive approach fees:	
Residential - \$20.00	
Business, Industrial, Residential (over 8 units) - \$30.00	
Special - \$50.00 (includes BZA application fee)	

# SIDEWALK, CURB OR CURB CUT PERMIT APPLICATION

## Work Zone Requirements

All requests for a Sidewalk and Curb Permit shall have a site plan attached showing the areas to be blocked or closed to the public and the signage, cones and/or barricades to be used.

All work zone set-ups within the City of Piqua street right-of-way shall comply with the requirements as set forth in the current Ohio Manual of Uniform Traffic Control Devices, OMUTCD.

The following are examples of approved cones, drums and barricades to be used.



\* Warning Lights (Optional)

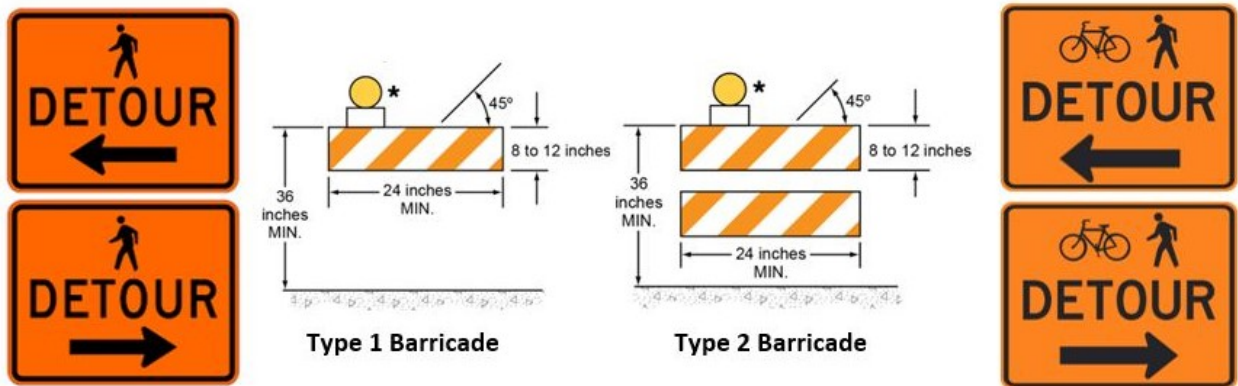

The Sides of Barricades Facing Traffic Shall Have Retroreflective Rail Faces